

SLENDER VILLAGE

NEW URBAN IDENTITY IN KAMPONG BHARU

WHAT

is a slender village?

- unprecedented typology
- smaller scale **mega tower**
- mini vertical city with **amenities of a sub-city**
- huge building complex that forms a micro society of its own
- new **development concept**

WHY

reinventing development?

- revolutionary development that enhances the **identity** of the area
- to be viable on heritage sites
- with minimal ground area impact
- be able to redevelop sensitive sites
- sensitive sites like **Kampong Bharu**

WHERE

Kampong Bharu

- >100 year old site situated at the heart of KL
- many old village buildings
- many **failed master plan** attempts
- redevelopment is inevitable** due to its location

VISION

IMAGINE CITY BLOCKS WITH **LESSER BUILDING FOOTPRINT**

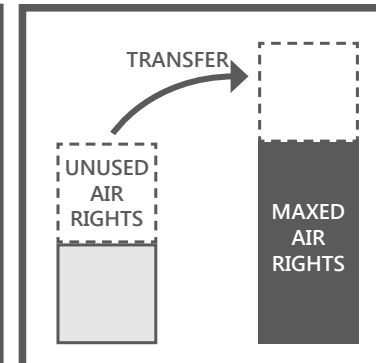
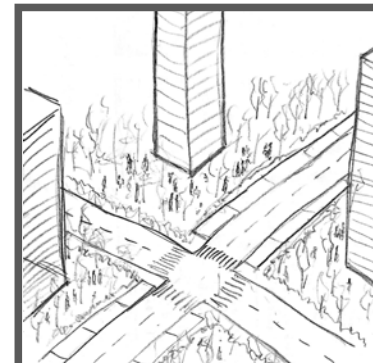
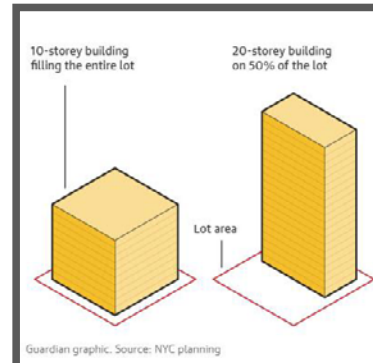
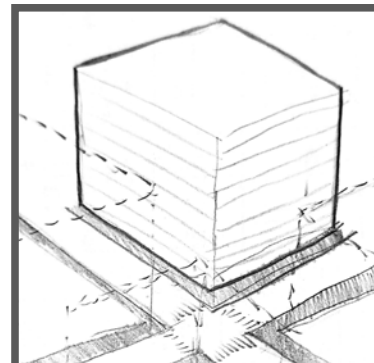

Need

Kampong Bharu requires redevelopment as it is the only remaining untouched area of the city. It is a very sensitive site, hence there is a need of a human-centric design approach.

Approach

To give back more open ground area to the public by consolidating the villages into slender vertical cities.

Benefits

Instead of sprawling development which creates boundaries and restrict movement, the vertical villages provide more open ground to reconnect people, hence reducing urban isolation.

Competitors

Existing master plan proposals by various parties were mostly investor-driven and they do not cater for the needs of those who live in Kampong Bharu.

SIMULATION BASED ON KAMPONG BHARU

ALL IN ONE MEGA TOWER

DECONSTRUCTED INTO MEGA BLOCKS

SLIMMED UP SLENDER TOWERS

FURTHER DISPERSION

SLENDER VILLAGES

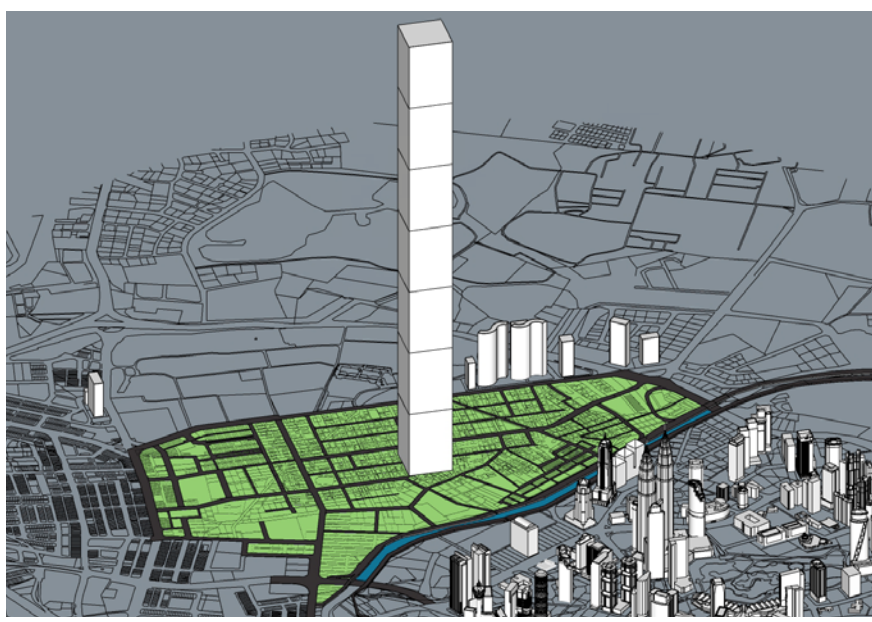
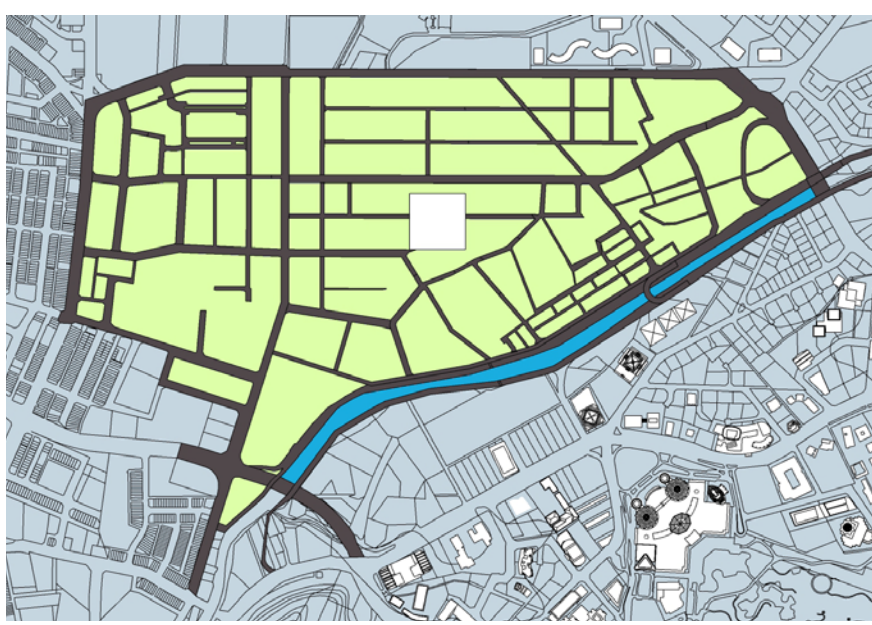

2058 acre of area into a single Mega Tower. All the rest of the lands shall be open spaces and no future development shall be permitted.

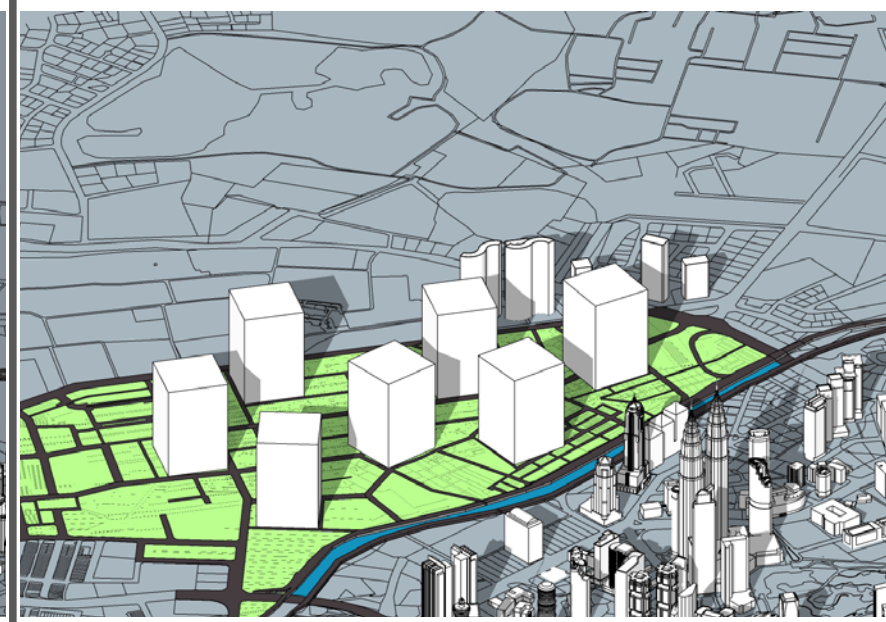
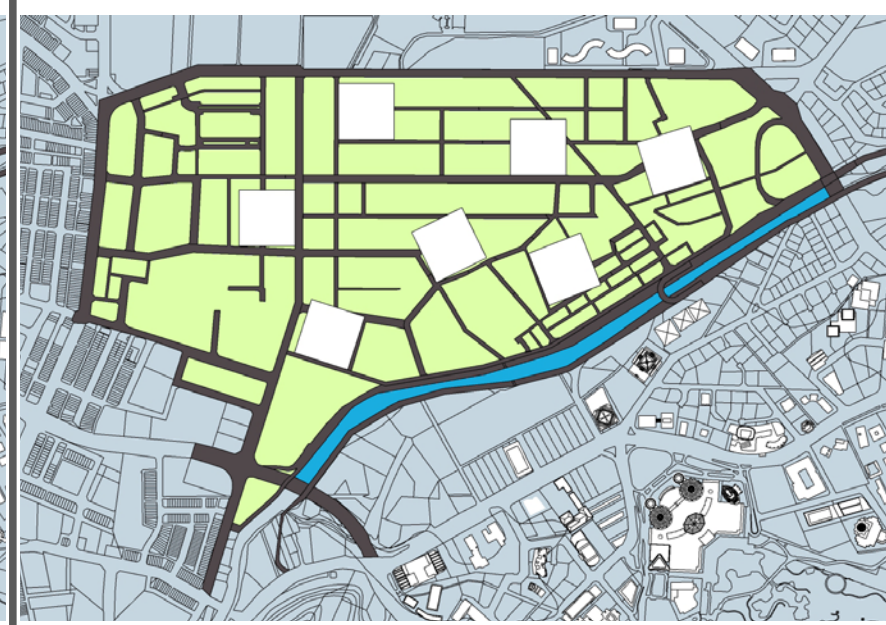

The Mega Tower is then deconstructed into 7 separate blocks based on the 7 villages of Kg Bharu and is then scattered around the region.

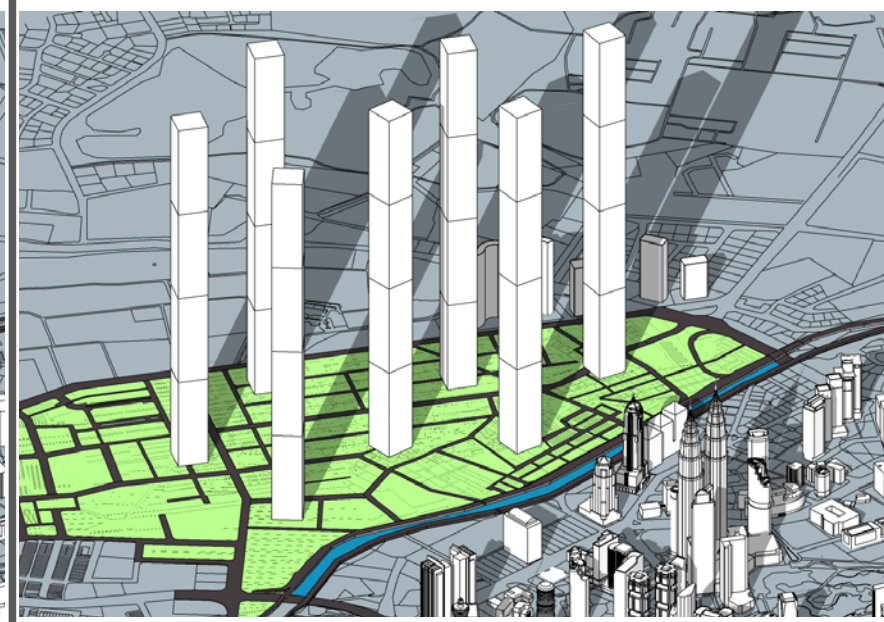
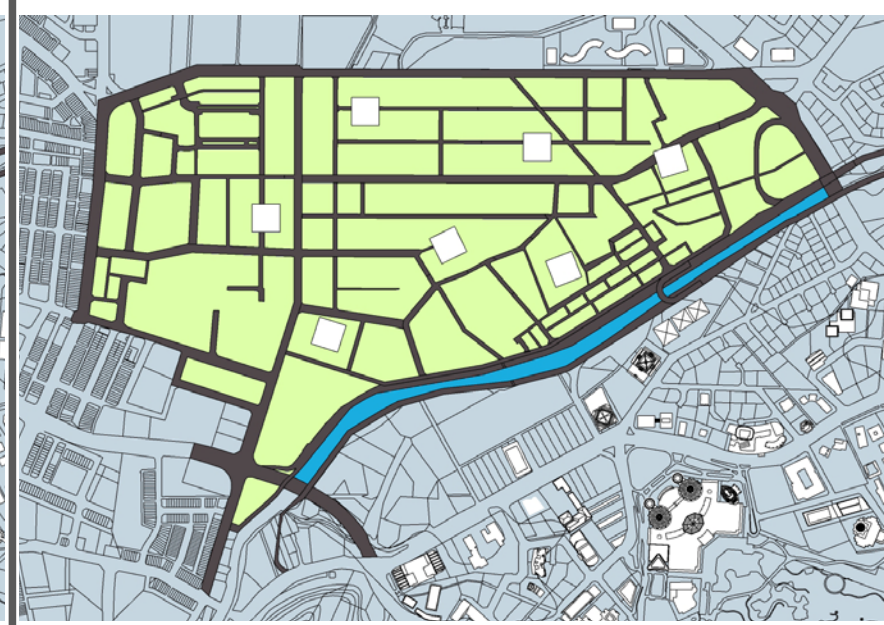

The bulky form of the mega blocks are then slimmed up into slender mega towers, however the height is too tall compared to the surrounding.

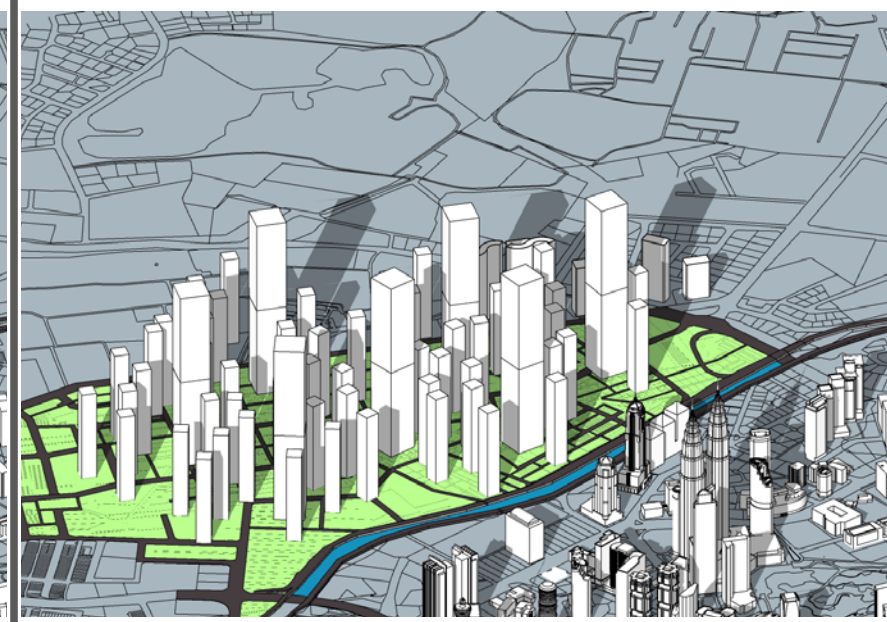
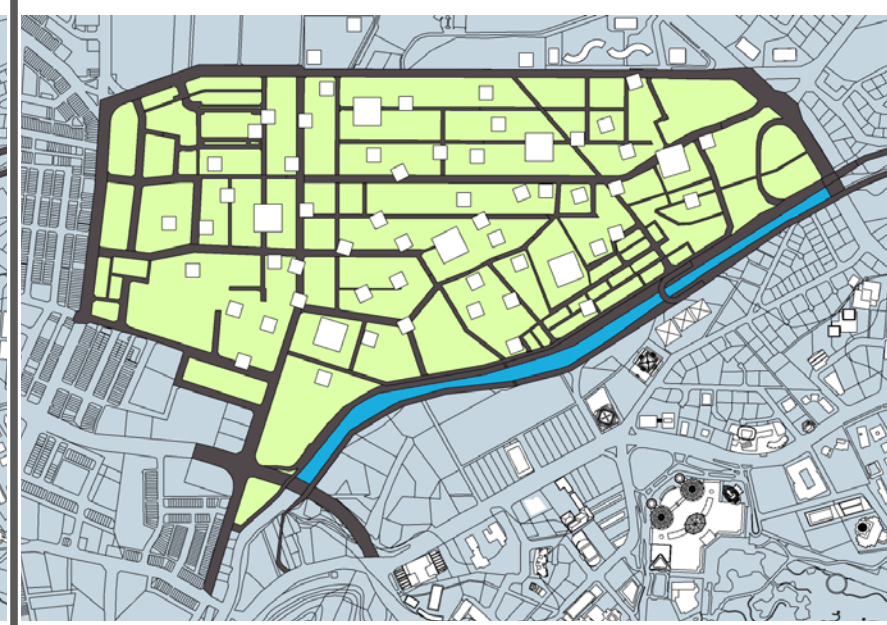

Half of the slender tower mass are then dispersed around each tower into smaller towers for a more even distribution of development.

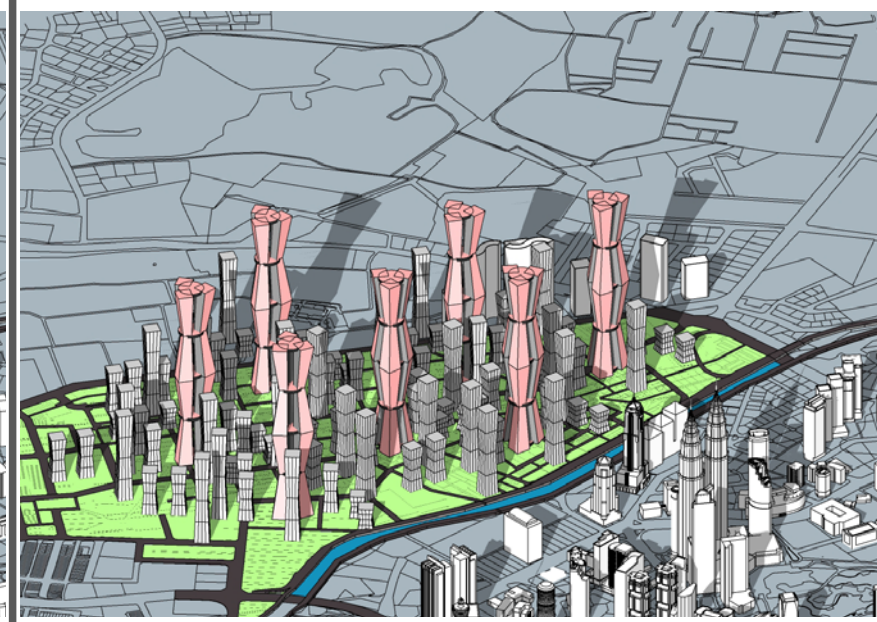
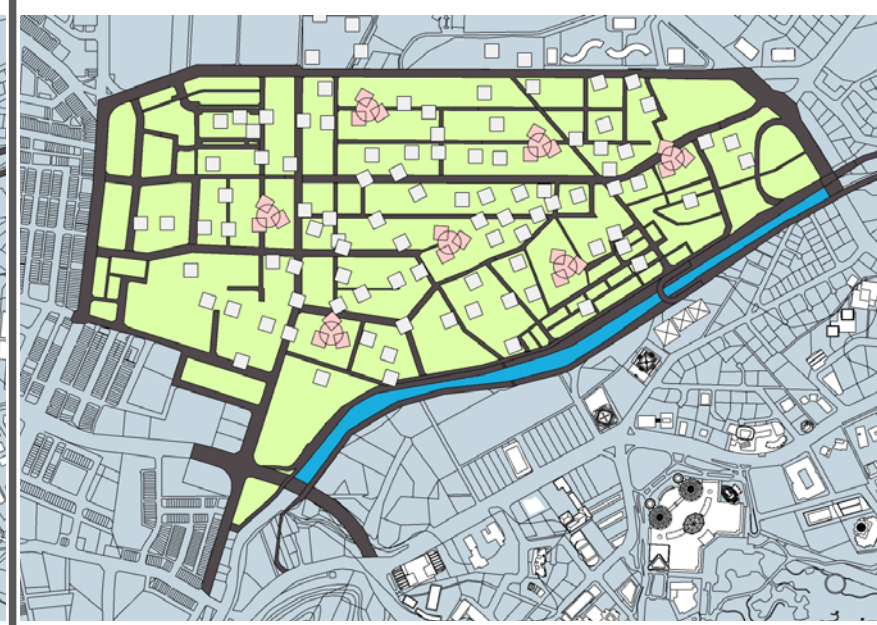

The smaller towers are then further deconstructed into various heights, the main buildings however will retain its mass and acts as the slender villages.

MASTER PLAN



CONSOLIDATION

The seven villages of Kampong Bharu shall be consolidated into tall sub-city towers, each with a specialised function. There will be slender tower complexes surrounding the iconic towers as well.

ICONIC NODES

The seven towers will be located along the proposed green belt that connects all the historical buildings of Kg Bharu.

PRESERVATION

The rest of the lands shall only be open for traditional houses as the air rights of these lands will be transferred to the towers.

SITE ANALYSIS & SYNTHESIS

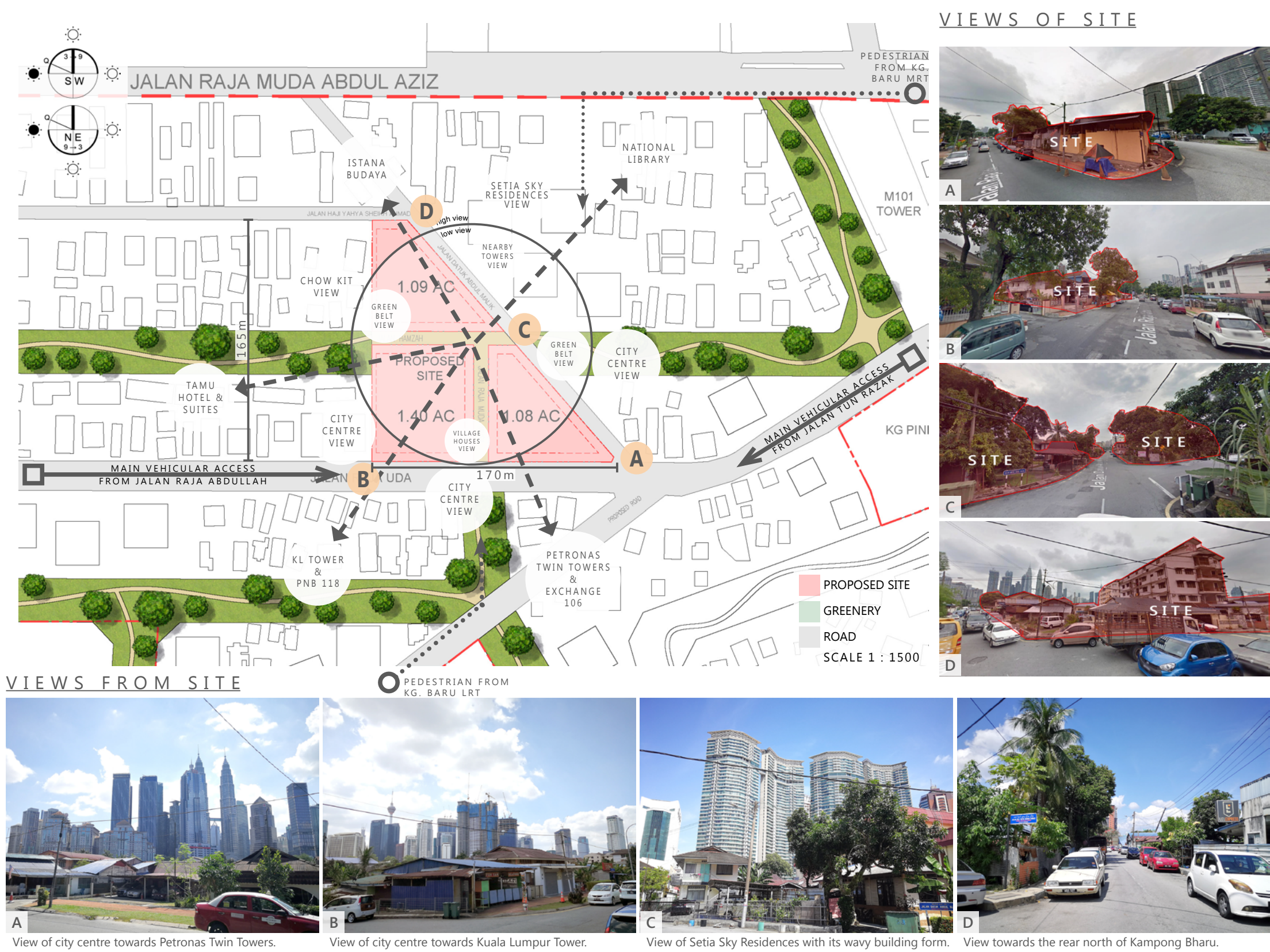

DESIGN APPROACH

BASE DESIGN

BASE PLANNING

Equilateral Tri-winged Layout
120° degrees on all sides that forms a balanced layout that provides the strongest structure.

Tilted to Fit
The layout was then tilted 10° degrees anti-clockwise to fit into the site.

Opening Spaces
The remaining untouched ground spaces shall be used for urban placemaking, there will not be any boundaries surrounding the development as it is to create seamless city boundaries

Sunken Ground

The ground will be lowered on the centre to expand visual space.

Wing Functions

Tower wings are to be named as shown on the left. Each wing will have its designated functions on specific floors. Express elevators that will lead visitors to the designated floors.

- Public function
- Residential
- Commercial
- Green Pods
- Green Space

SPACE PROGRAMMING

SECTIONAL DESIGN

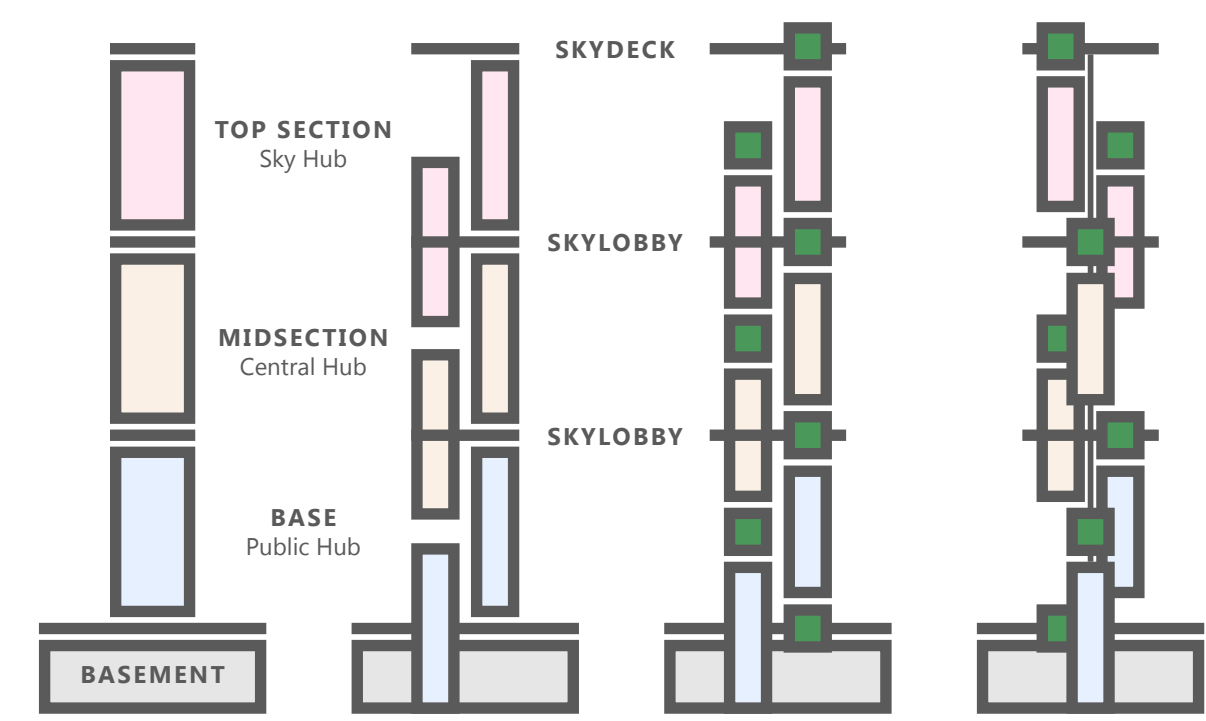

Division
The tower will be divided into 3 equal portions with 2 sky lobby. Each portion is a self-sustaining hub, it is like towers within a massive tower.

Segmentation
Each portion is then segmented into 2 parts, totalling 6 parts. They are then arranged in a spiral fashion interlocking with immediate

Clusterisation
Clusters of open spaces will be squeezed in between segments to evenly spread open spaces throughout the tower.

Tri-winged
The tower is then configured in a tri-winged layout based on the study above. The segments and clusters will be arranged in a spiral fashion.

- RESIDENTIAL QUARTERS**
1100+ units
400 - 1000 sqft
- COMMERCE CENTRES**
550+ units
400 - 2000 sqft
- OFFICE COMPLEXES**
350+ units
1000 - 4500 sqft
- PUBLIC SPACES**
TOWNHALL
COMMUNITY HUB
AMPHITHEATRE
VIEWING DECKS
- GREEN SPACES**
PARKS
GARDENS
PLAYGROUNDS

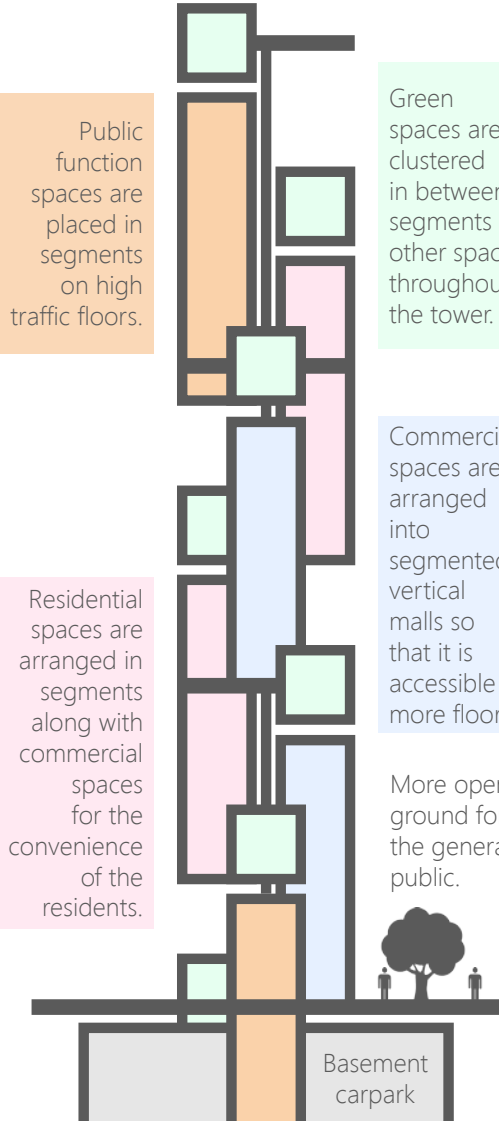

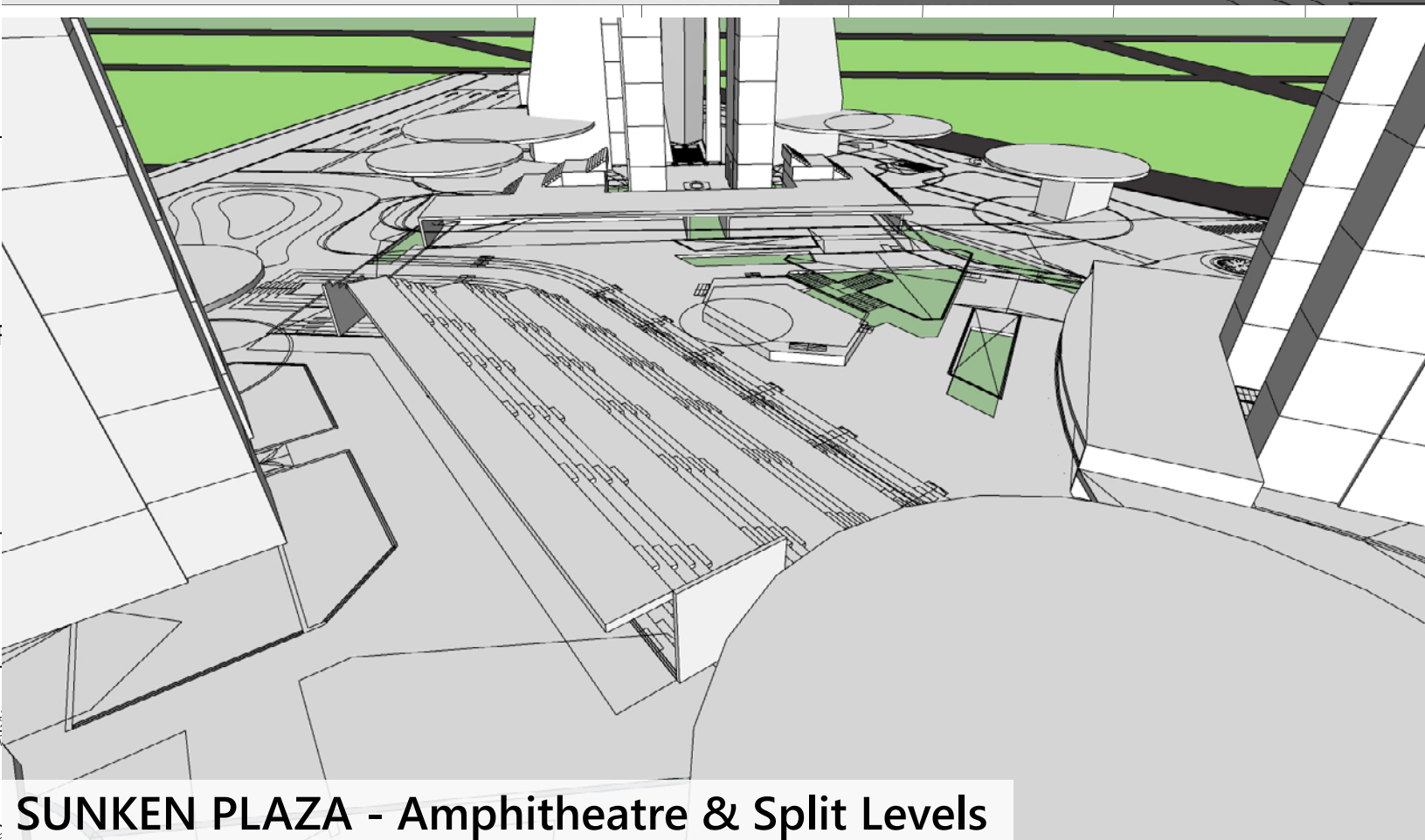
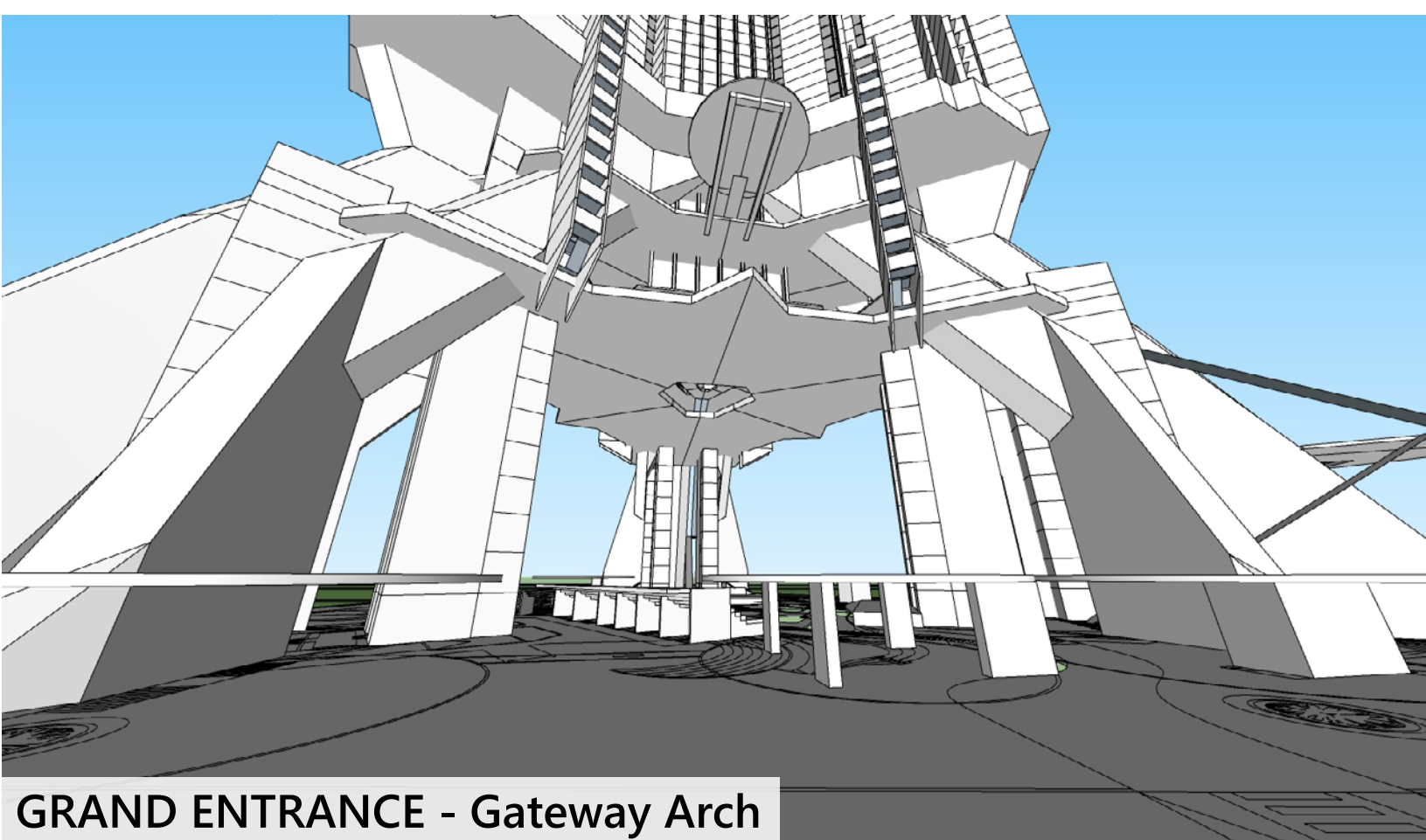
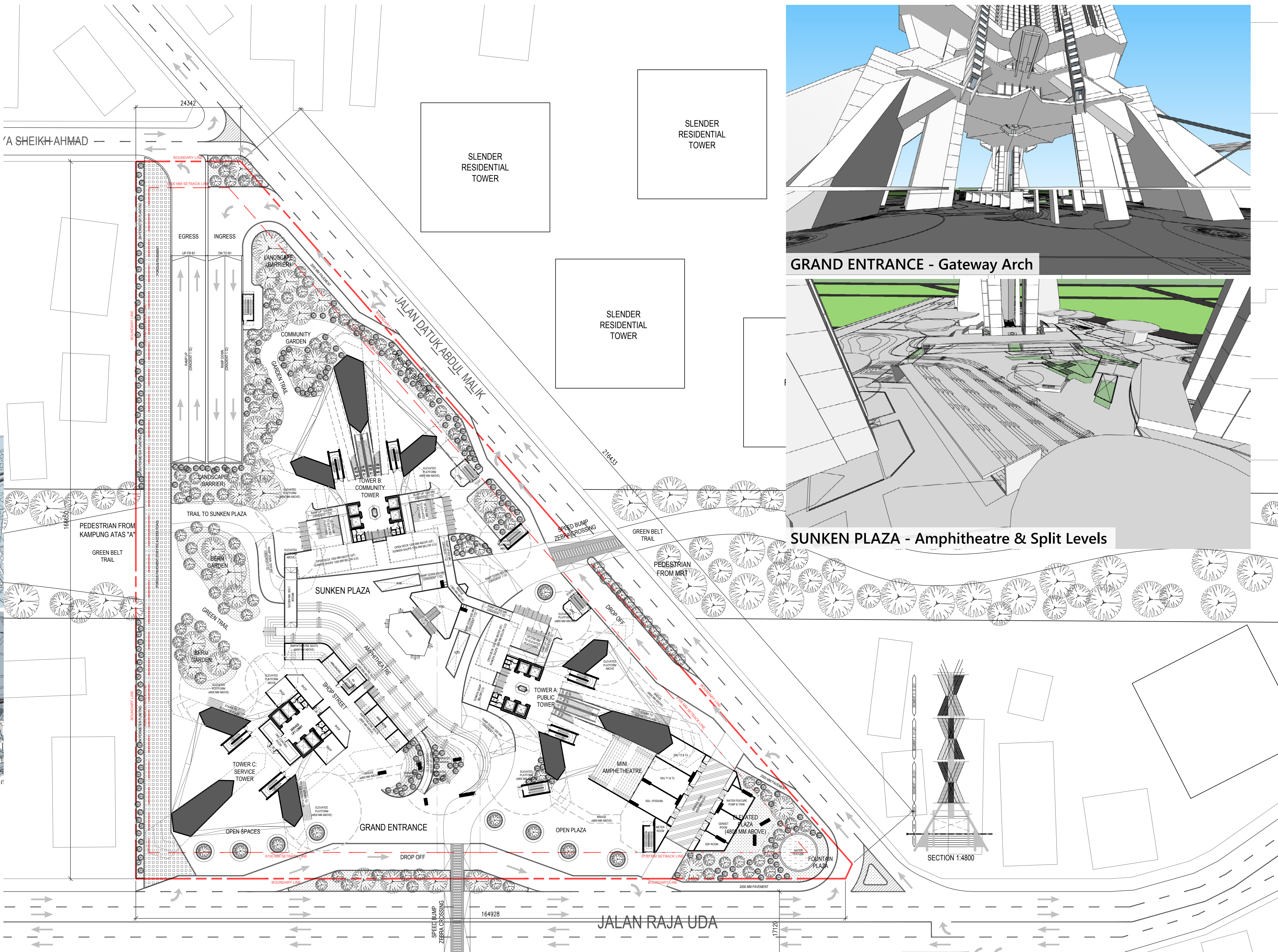

1 GROUND FLOOR PLAN
MAIN PLAZA
SCALE 1:600

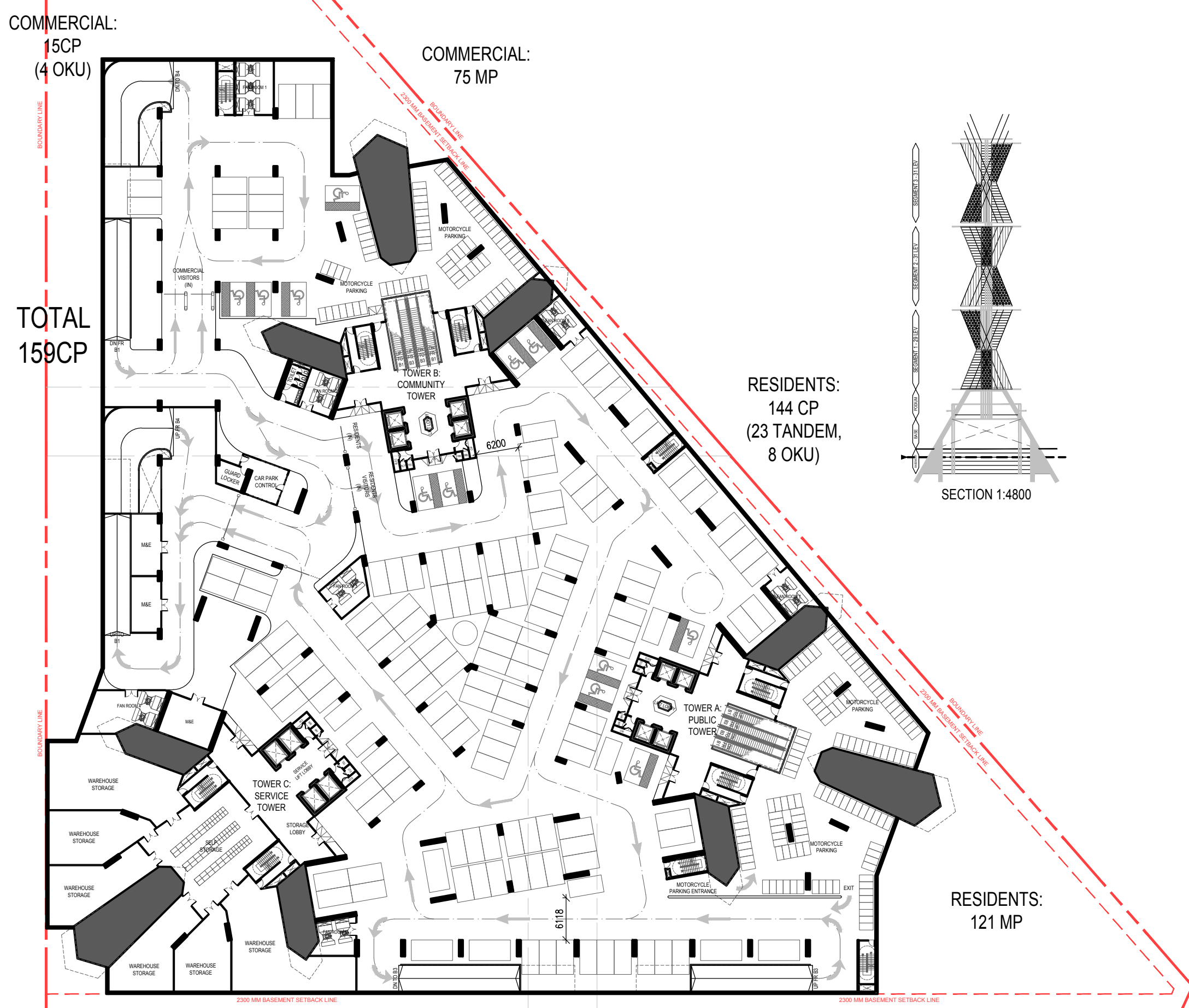

1 BASEMENT 2 PLAN
RESIDENTIAL CAR PARK [FFL: -8.00]
SCALE 1:600

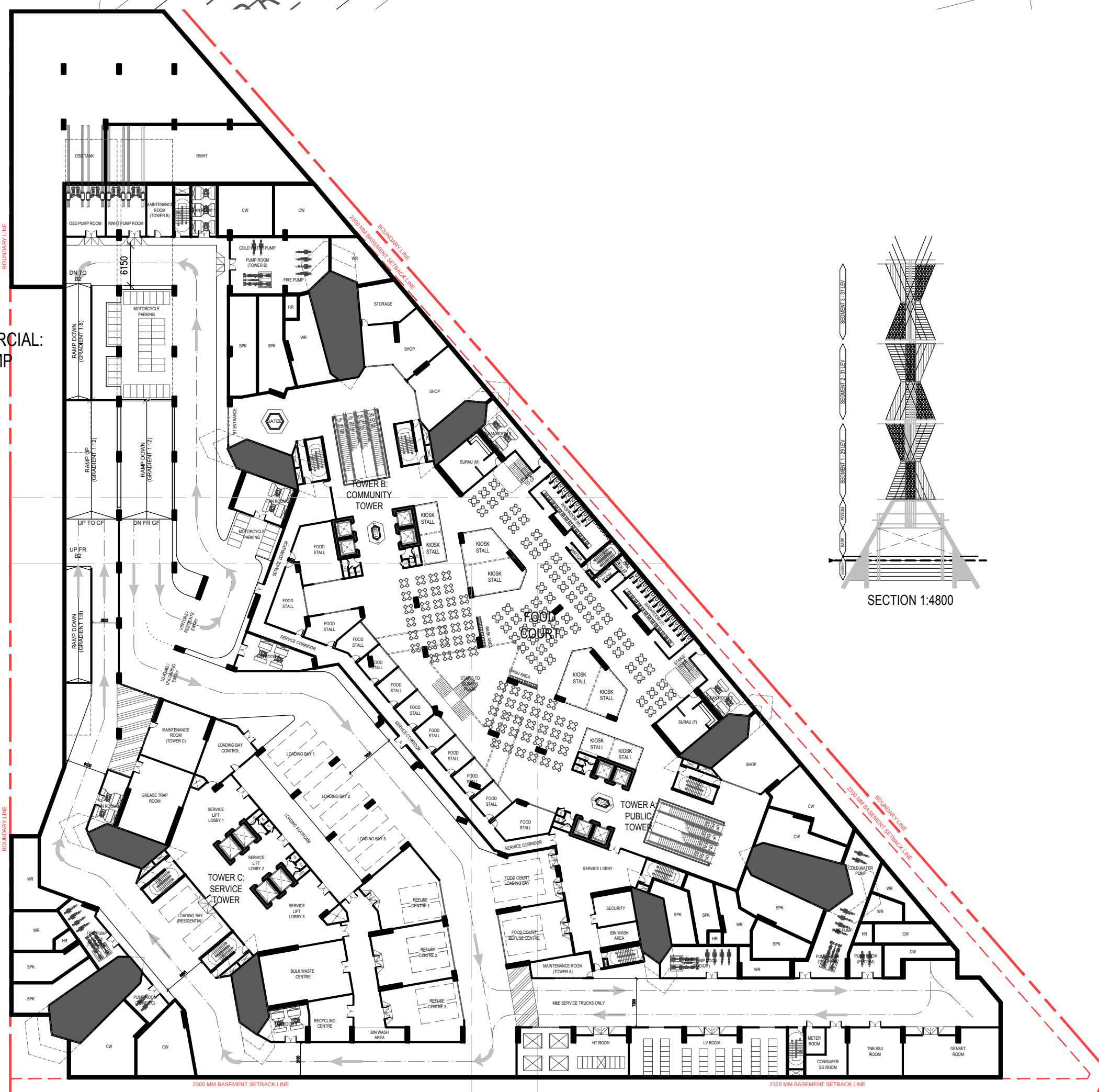

1 BASEMENT 1 PLAN
RESIDENTIAL CAR PARK [FFL: -4.80]
SCALE 1:600

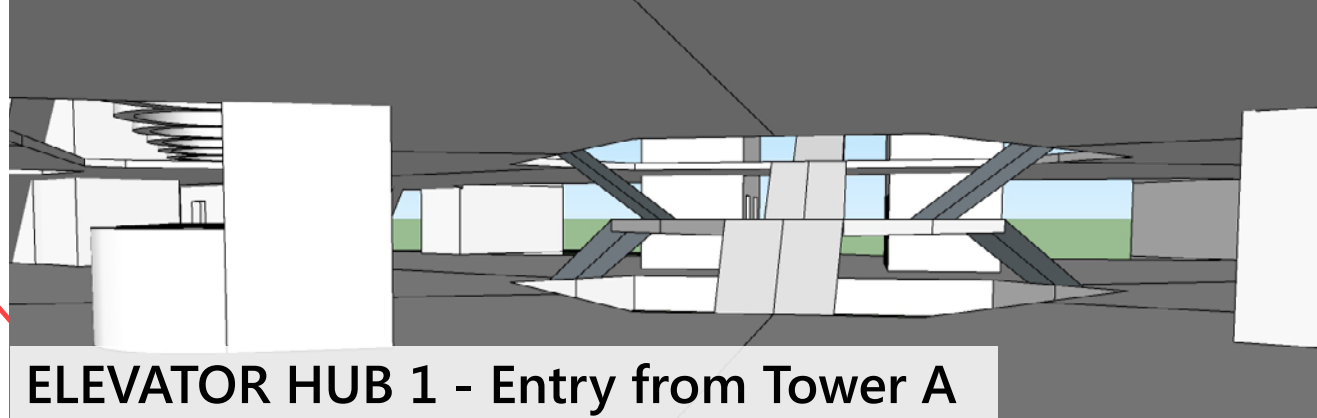

ELEVATOR HUB 1 - Entry from Tower A

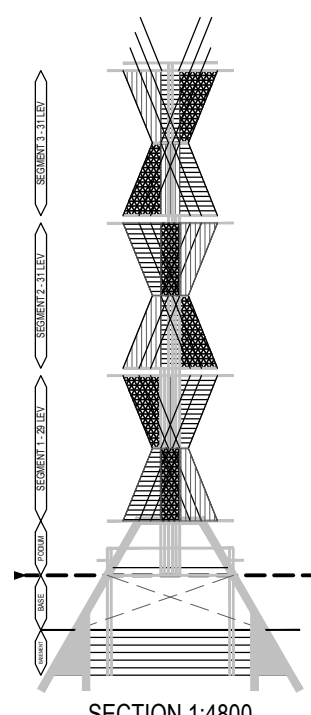

SECTION 1:4800

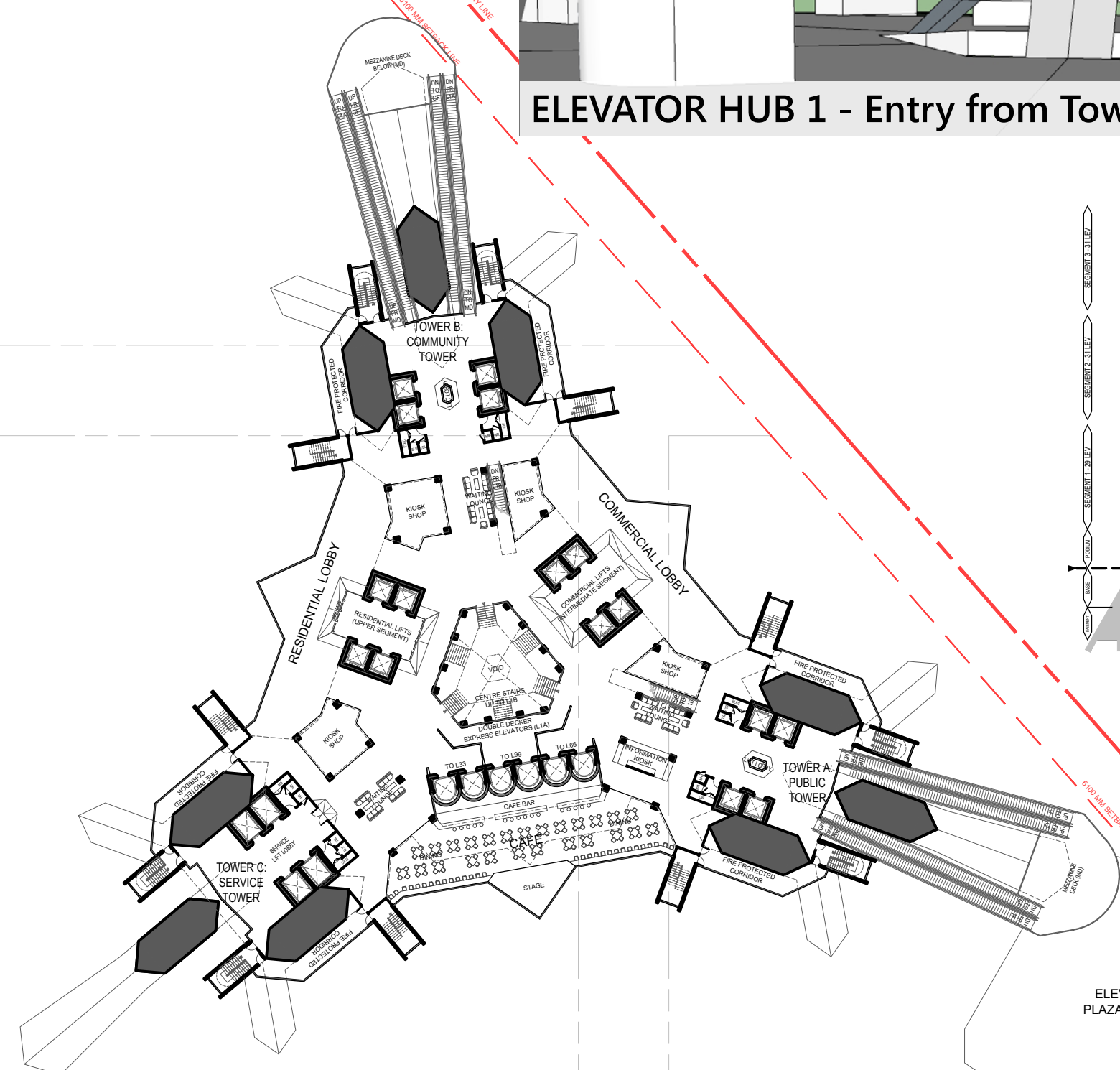

4 LEVEL 1A
- ELEVATOR HUB A [FFL: +30.60]
SCALE 1:400

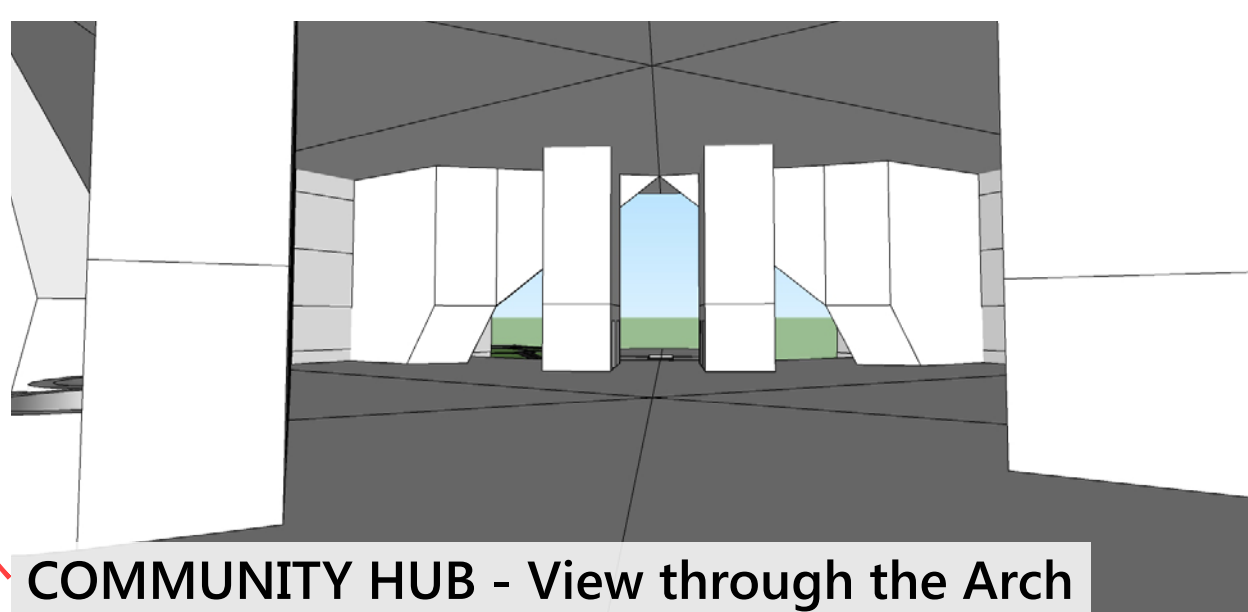
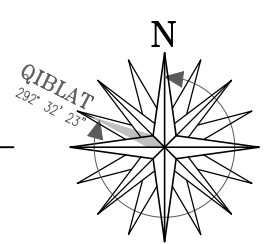

COMMUNITY HUB - View through the Arch

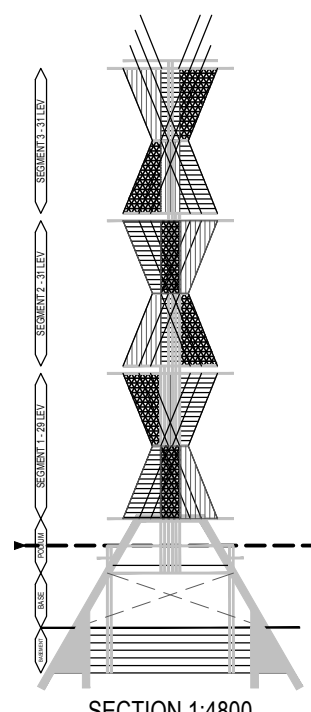

SECTION 1:4800

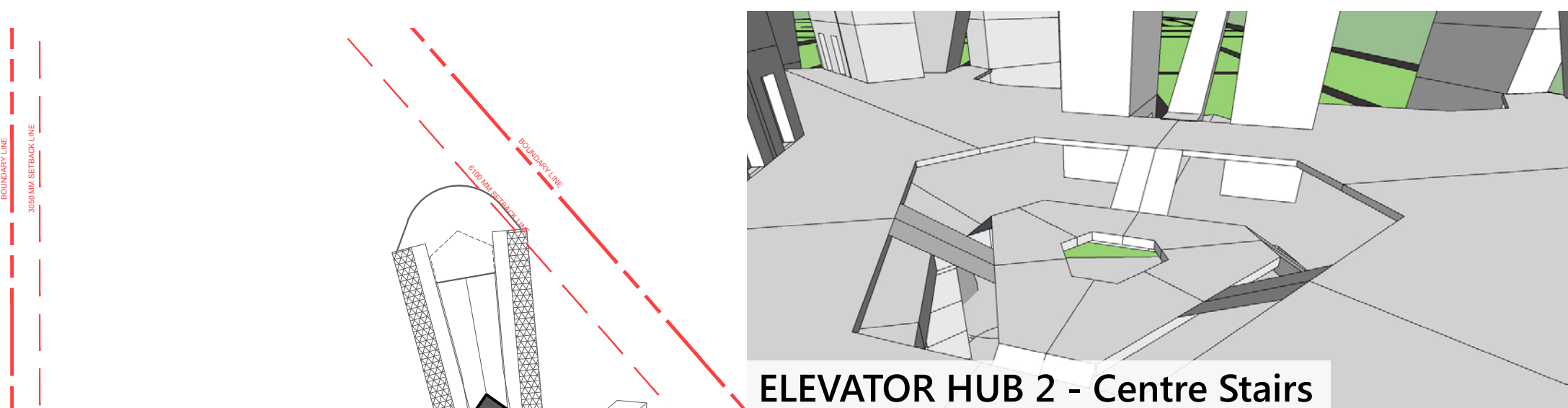
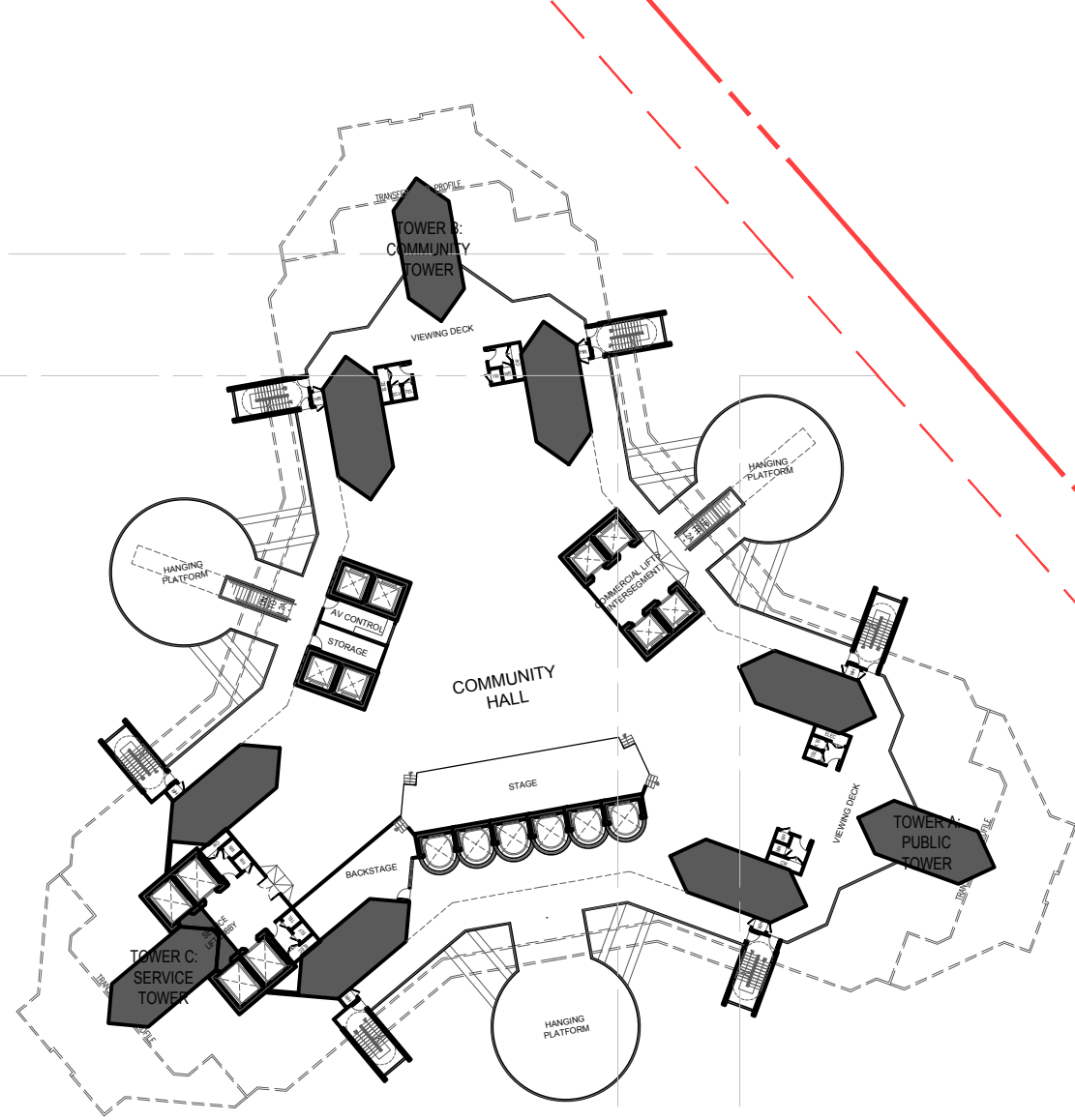

ELEVATOR HUB 2 - Centre Stairs

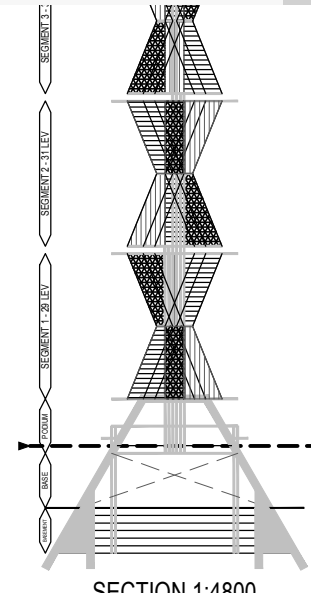

SECTION 1:4800

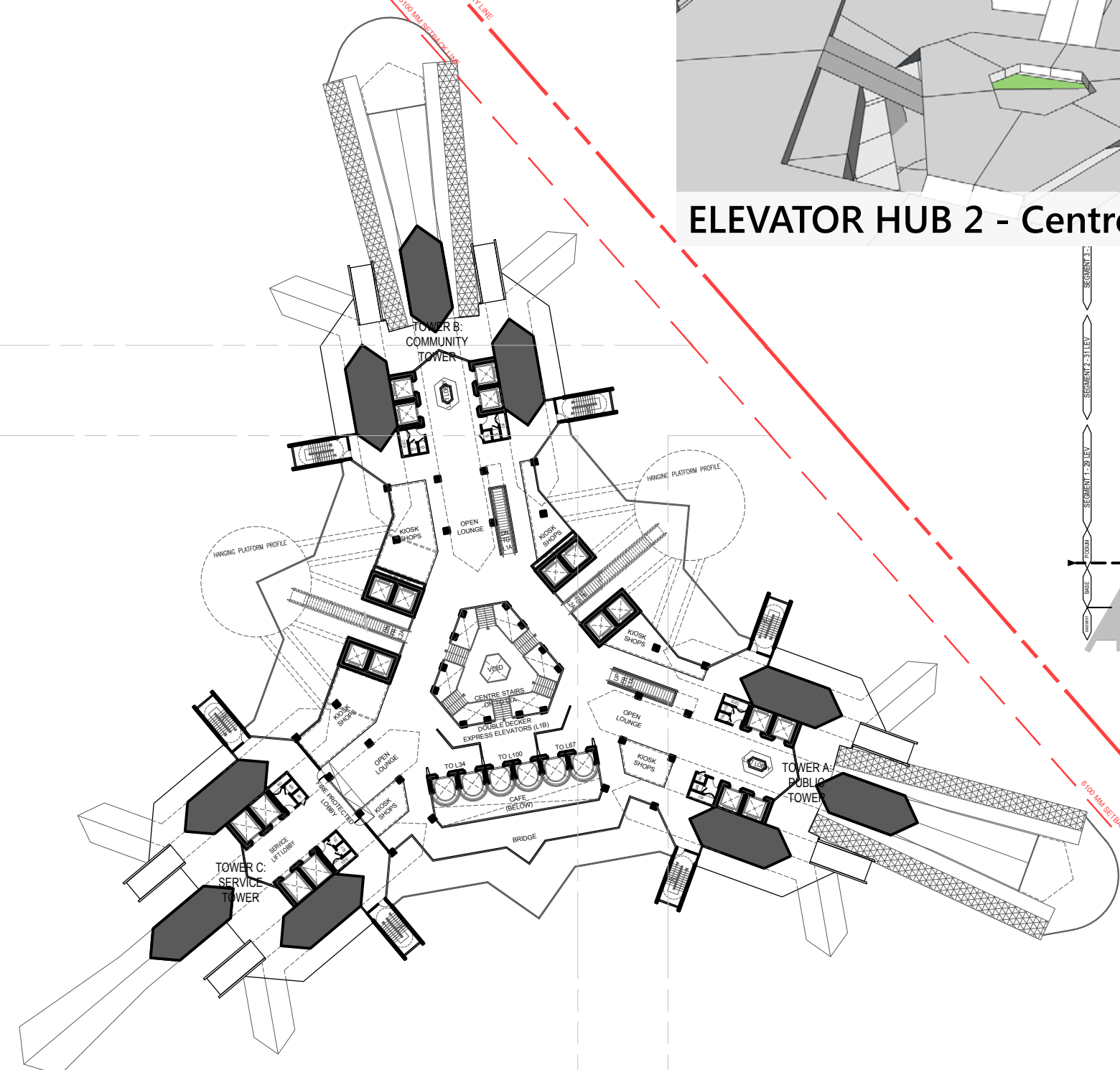

5 LEVEL 1B
- ELEVATOR HUB B [FFL: +33.80]
SCALE 1:400

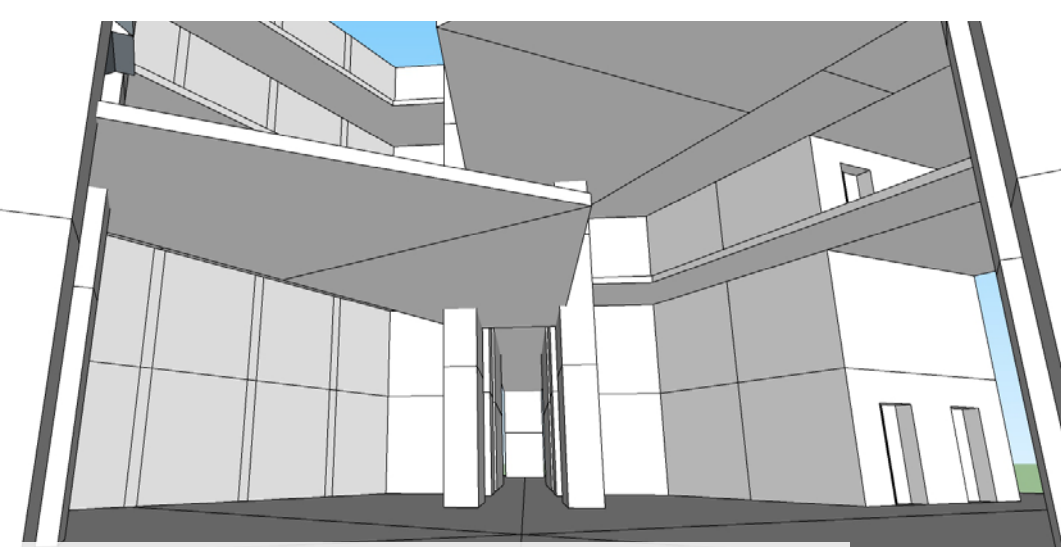
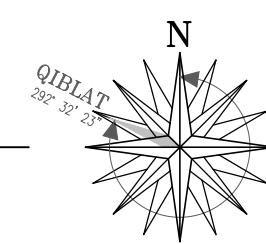

PODIUM - Tower Connector Above

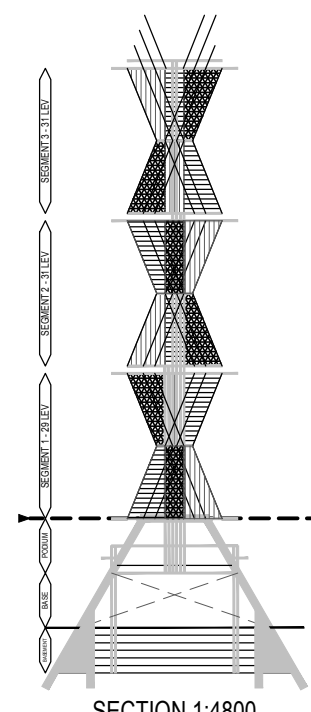

SECTION 1:4800

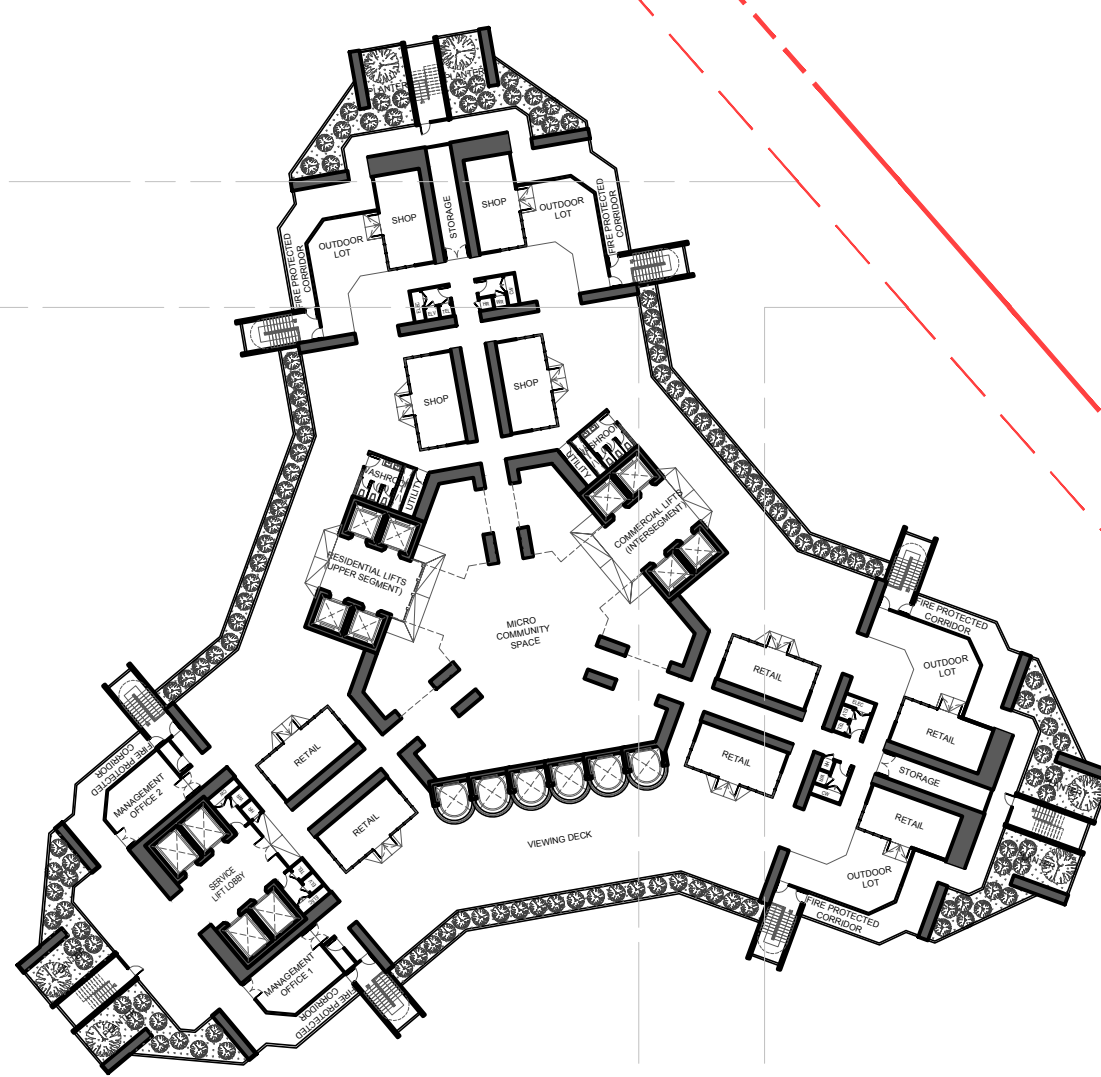

6 LEVEL 2
- COMMUNITY HUB [FFL: +45.90]
SCALE 1:400

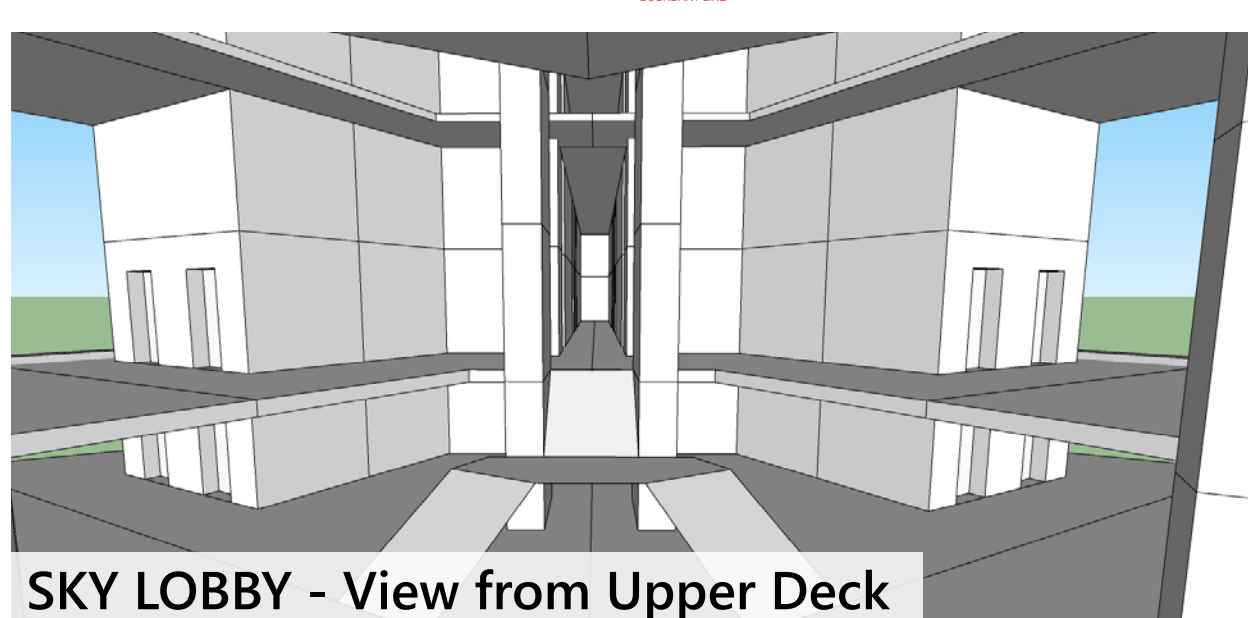
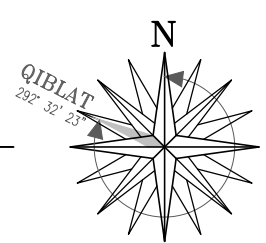

SKY LOBBY - View from Upper Deck

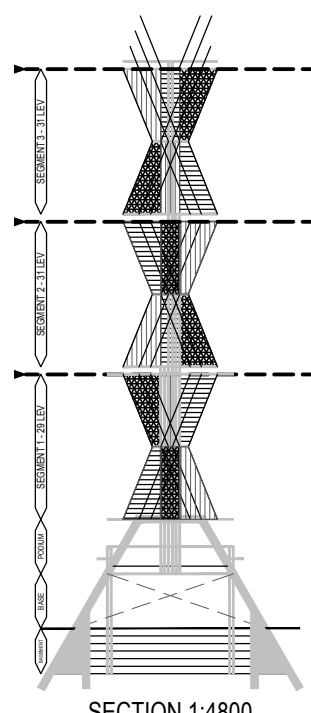

SECTION 1:4800

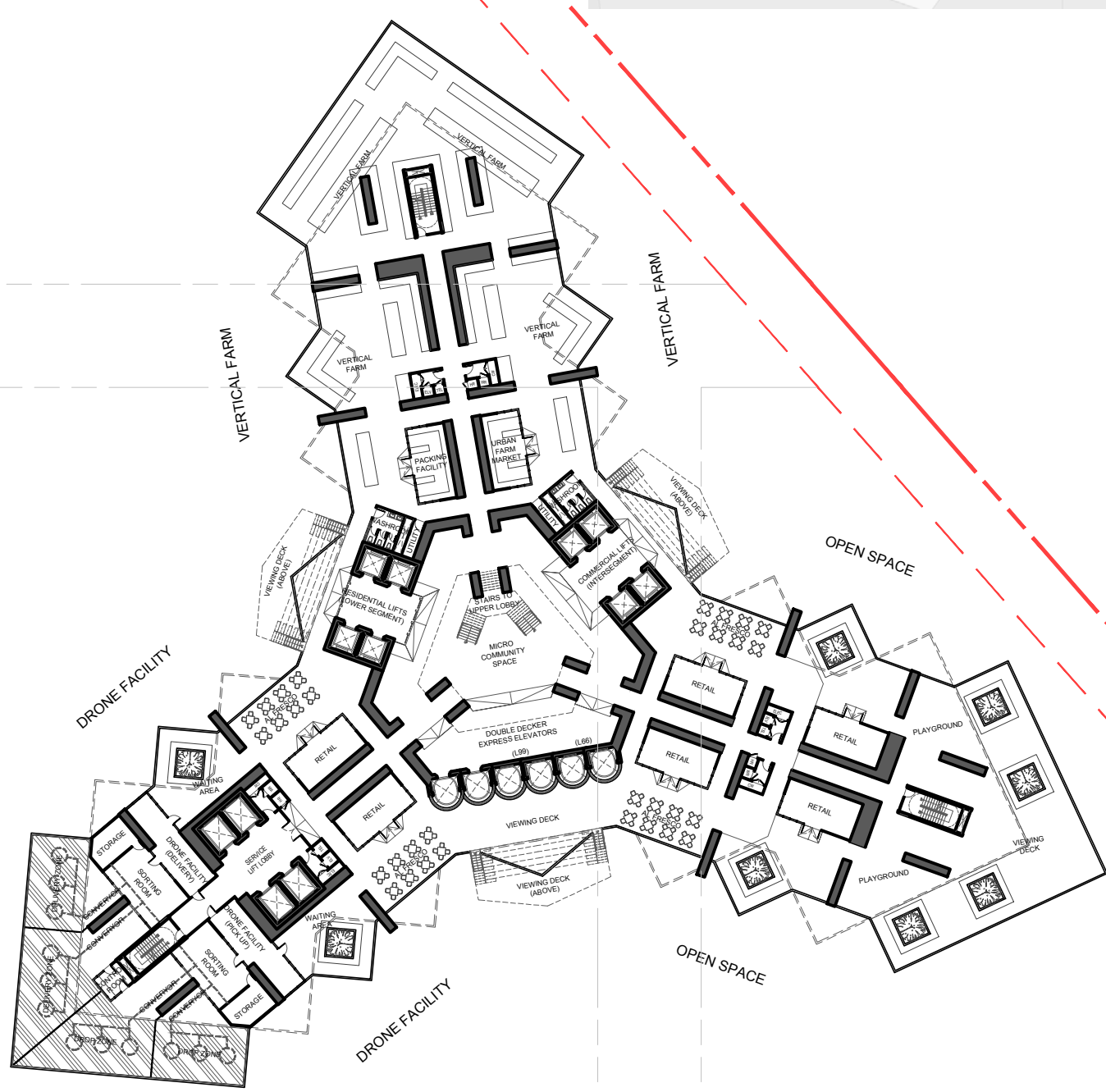

7 LEVEL 3
- PODIUM [FFL: +61.20]
SCALE 1:400

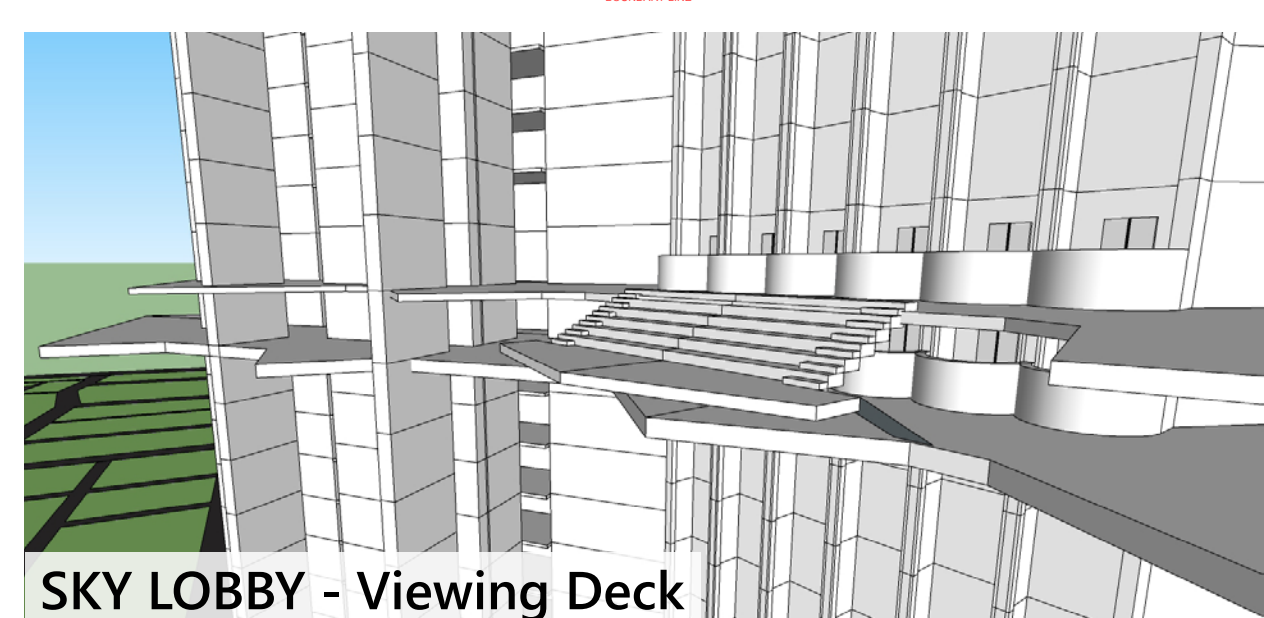
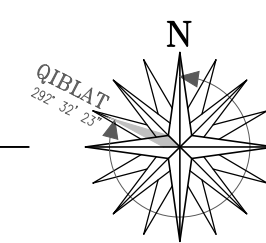

SKY LOBBY - Viewing Deck

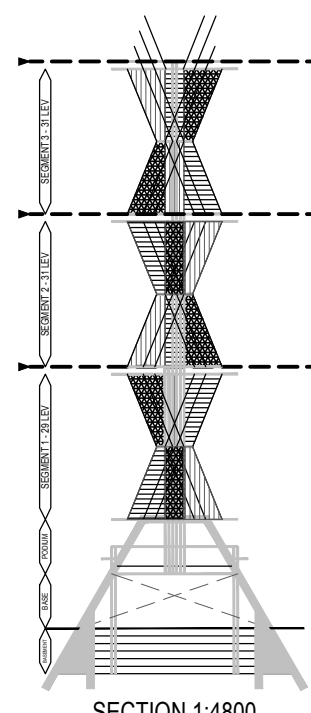

SECTION 1:4800



8 LEVEL 33, 66 & 99
- SKY LOBBY (LOWER) [FFL: +157.20]
SCALE 1:400

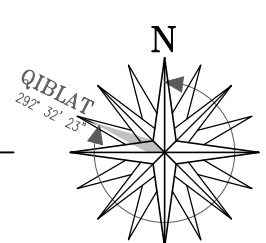

9 LEVEL 34, 67, 100
- SKY LOBBY (UPPER) [FFL: +371.60]
SCALE 1:400

